

A True Partnership



PROUDLY CANADIAN

GENYK

Polyurethane



SYSTEMS FOR APPLICATION OF
POLYURETHANE AND POLYUREA

DURAFLEX.

BOREAL NATURE
ELITE

Vapour Barrier Solution:

Protects against moisture, preventing mold and preserving your space's integrity.

Efficient Radon Barrier :

Seal out harmful radon. Certified protection for your health and home.

Ideal for Renovations:

Easy to apply in tight spaces, offering seamless upgrades for better efficiency and comfort.

High Performance & Durability:

Reliable insulation that delivers long-term energy efficiency and cost savings.

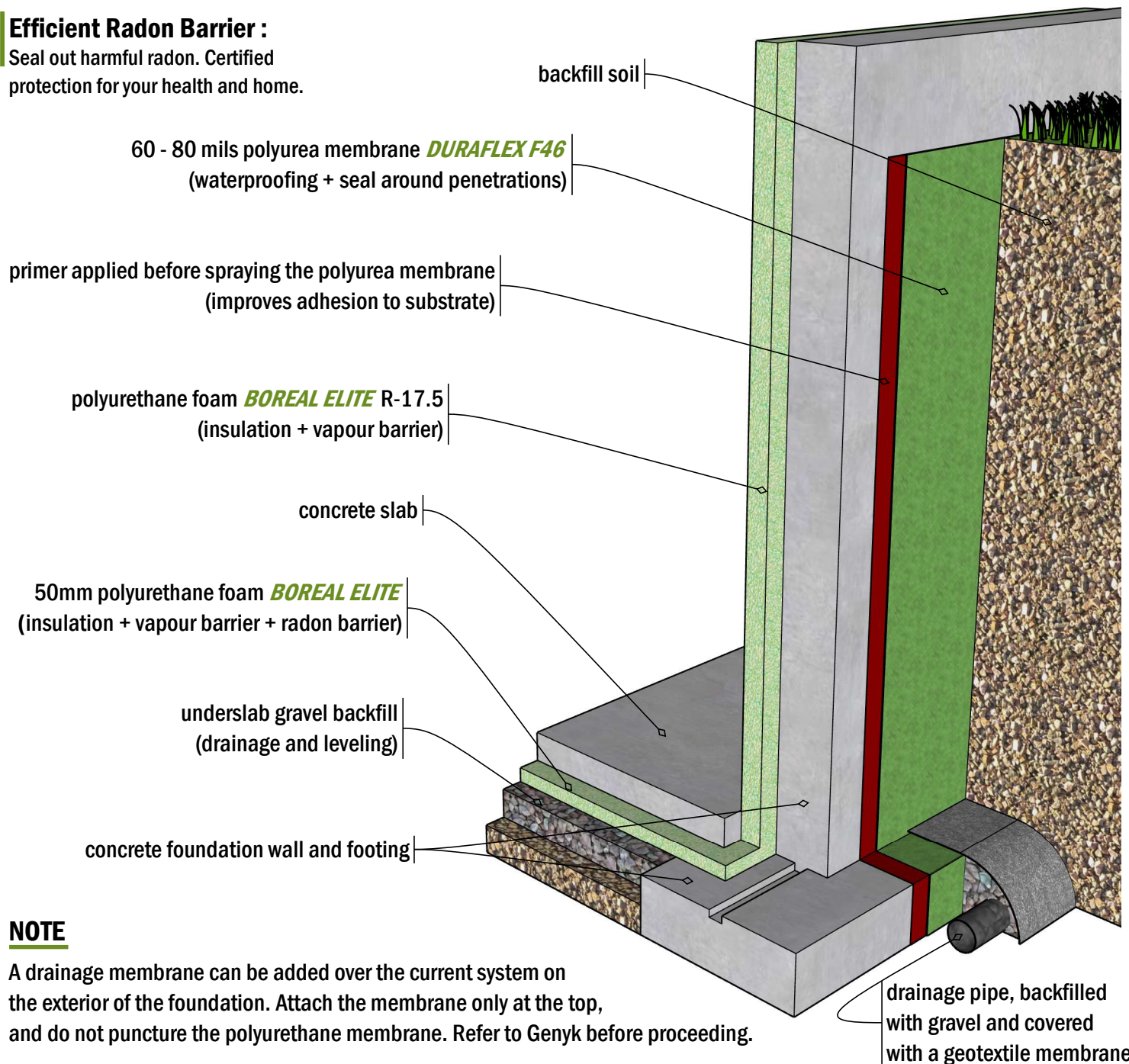

NOTE

A drainage membrane can be added over the current system on the exterior of the foundation. Attach the membrane only at the top, and do not puncture the polyurethane membrane. Refer to Genyk before proceeding.

+ please ensure compliance with local authority regulations concerning the R-values & the vapour barrier of the assemblies

LEGEND

- BOREAL ELITE
- DURAFLEX F46

PIERRE-LUC ST-LOUIS - Building Science Technician

DATE

May 2nd, 2025

REV #

REV-0



- Vapour Barrier Solution:

Protects against moisture, preventing mold and preserving your space’s integrity.
- High Waterproofing Efficiency:

Protects against water damage, ensuring your space stays dry and secure.
- High Performance & Durability:

Reliable insulation that delivers long-term energy efficiency and cost savings.

solvent based, aliphatic polyurethane top coat.

(the polyurea membrane will change colour without affecting its durability, aliphatic finishing paints are not necessary but can be used to cover the membrane if colour retention is desired)

the membrane can be interrupted at the floor level for other types of finishing coatings, such as stucco, cement-based, or acrylic finishes

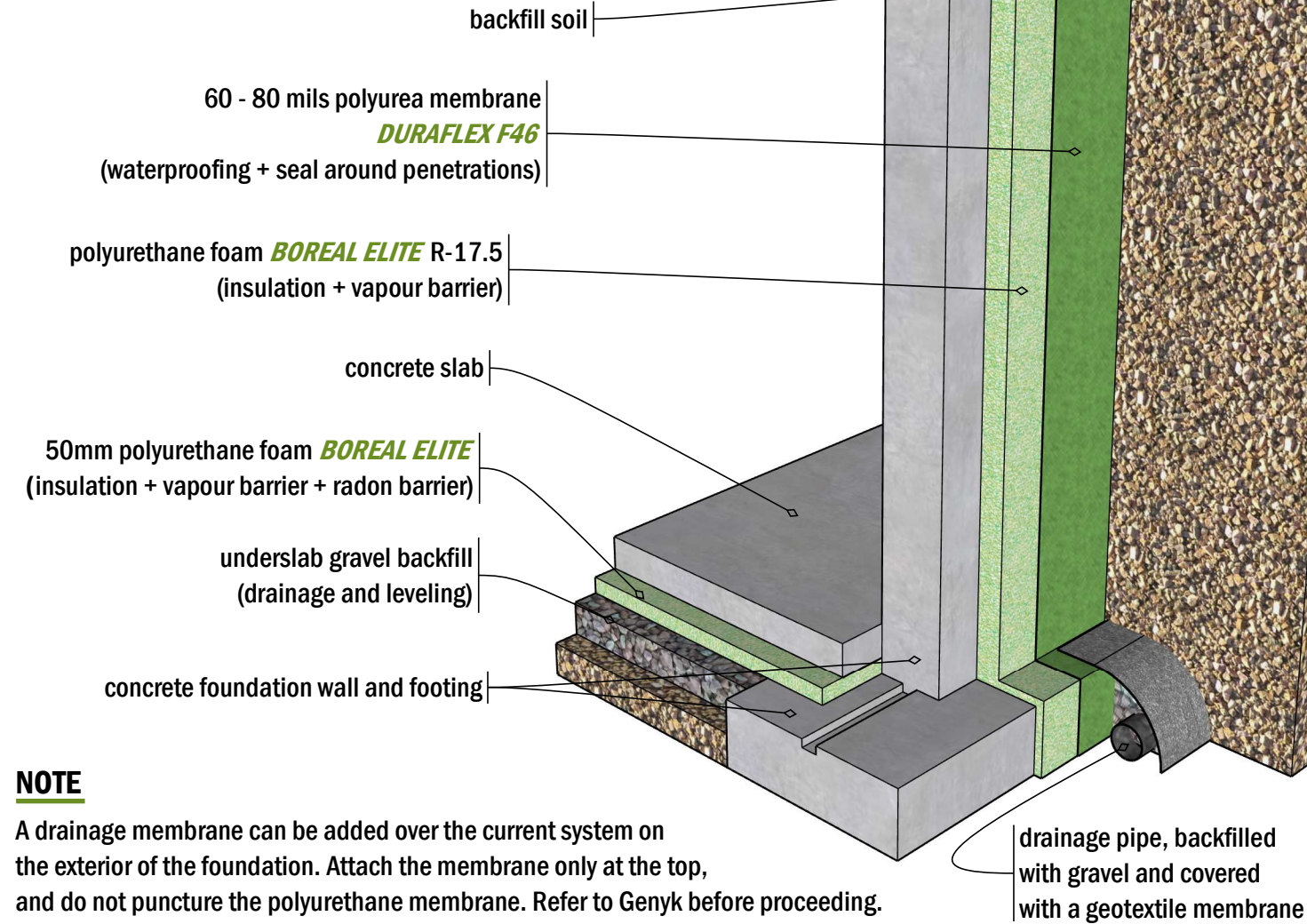

NOTE

A drainage membrane can be added over the current system on the exterior of the foundation. Attach the membrane only at the top, and do not puncture the polyurethane membrane. Refer to Genyk before proceeding.

+ please ensure compliance with local authority regulations concerning the R-values & the vapour barrier of the assemblies

| LEGEND | | PIERRE-LUC ST-LOUIS - Building Science Technician | |
|---|----------------------------|---|--|
| <div>BOREAL ELITE</div> <div>DURAFLEX F46</div> | DATE | REV # | |
| | May 2 nd , 2025 | REV-0 | |

Ideal for Renovation:

Seamless integration into existing structures, enhancing comfort and efficiency with minimal disruption.

Efficient Radon Barrier :

Seal out harmful radon. Certified protection for your health and home.

Vapour Barrier Solution:

Protects against moisture, preventing mold and preserving your space's integrity.

High Performance & Durability:

Reliable insulation that delivers long-term energy efficiency and cost savings.

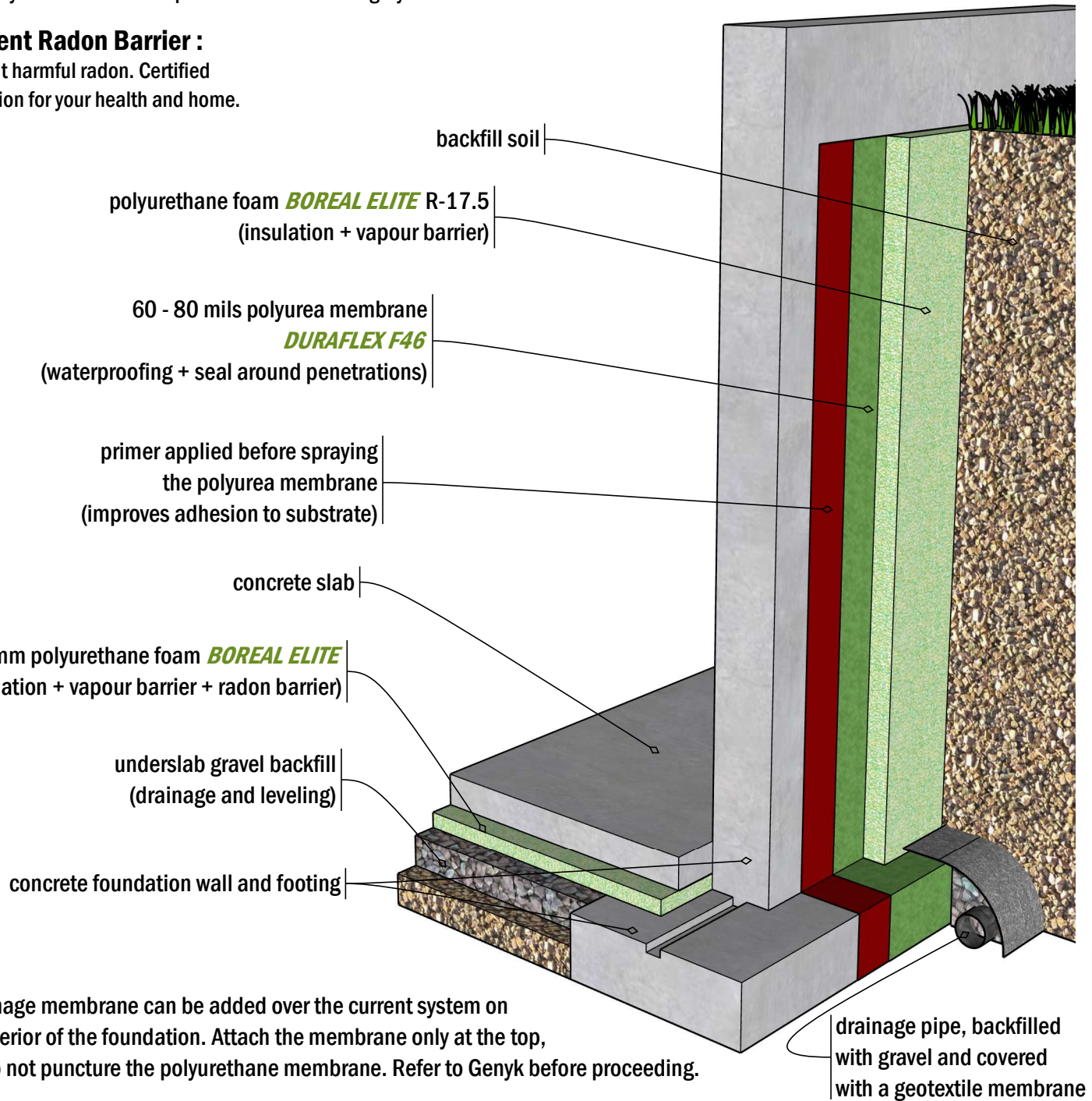

NOTE

A drainage membrane can be added over the current system on the exterior of the foundation. Attach the membrane only at the top, and do not puncture the polyurethane membrane. Refer to Genyk before proceeding.

+ please ensure compliance with local authority regulations concerning the R-values & the vapour barrier of the assemblies

LEGEND

| | | | |
|--|--------------|--|--------|
| | BOREAL ELITE | | PRIMER |
| | DURAFLEX F46 | | |

PIERRE-LUC ST-LOUIS - Building Science Technician

DATE

REV #

May 2nd, 2025

REV-0

**PROUDLY
CANADIAN.**

Vapour Barrier Solution:

Seals out moisture to protect your property and improve indoor air quality.

High Performance:

Exceptional insulation for long-term energy savings and year-round comfort.

Rapid Deployment:

Fast, efficient application to upgrade your space with minimal downtime.

Efficient Radon Barrier :

Seal out harmful radon. Certified protection for your health and home.

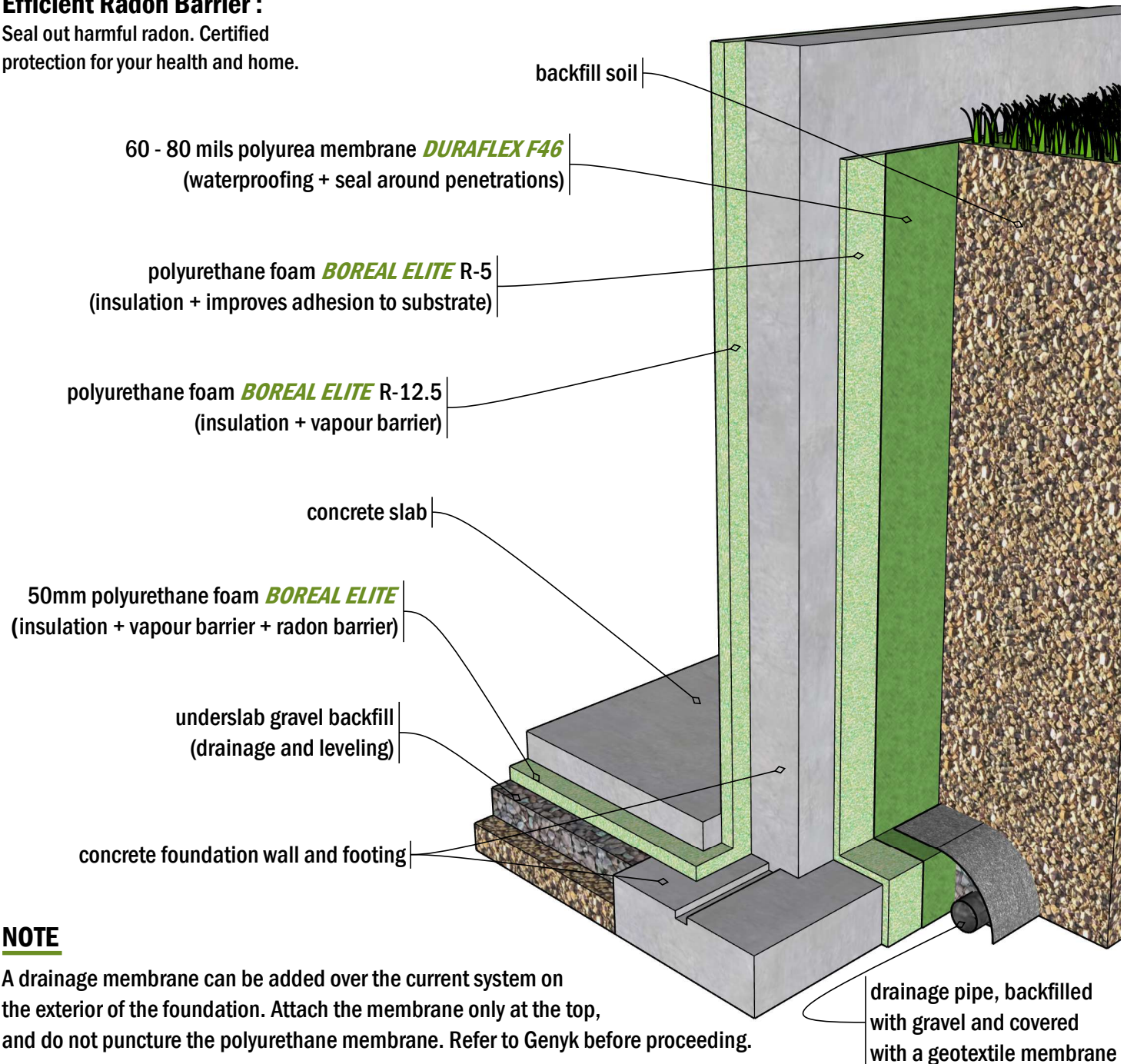

NOTE

A drainage membrane can be added over the current system on the exterior of the foundation. Attach the membrane only at the top, and do not puncture the polyurethane membrane. Refer to Genyk before proceeding.

+ please ensure compliance with local authority regulations concerning the R-values & the vapour barrier of the assemblies

LEGEND

- BOREAL ELITE
- DURAFLEX F46

PIERRE-LUC ST-LOUIS - Building Science Technician

DATE

May 2nd, 2025

REV #

REV-0

**PROUDLY
CANADIAN.**

High Performance & Durability:

Delivers reliable insulation and long-term structural resilience.

Efficient Radon Barrier :

Seal out harmful radon. Certified protection for your health and home.

Effective for High Water Table:

Engineered to resist groundwater pressure, ensuring dry, protected spaces even in challenging conditions.

Vapour Barrier Solution:

Prevents moisture build-up, enhancing indoor comfort and safeguarding materials.

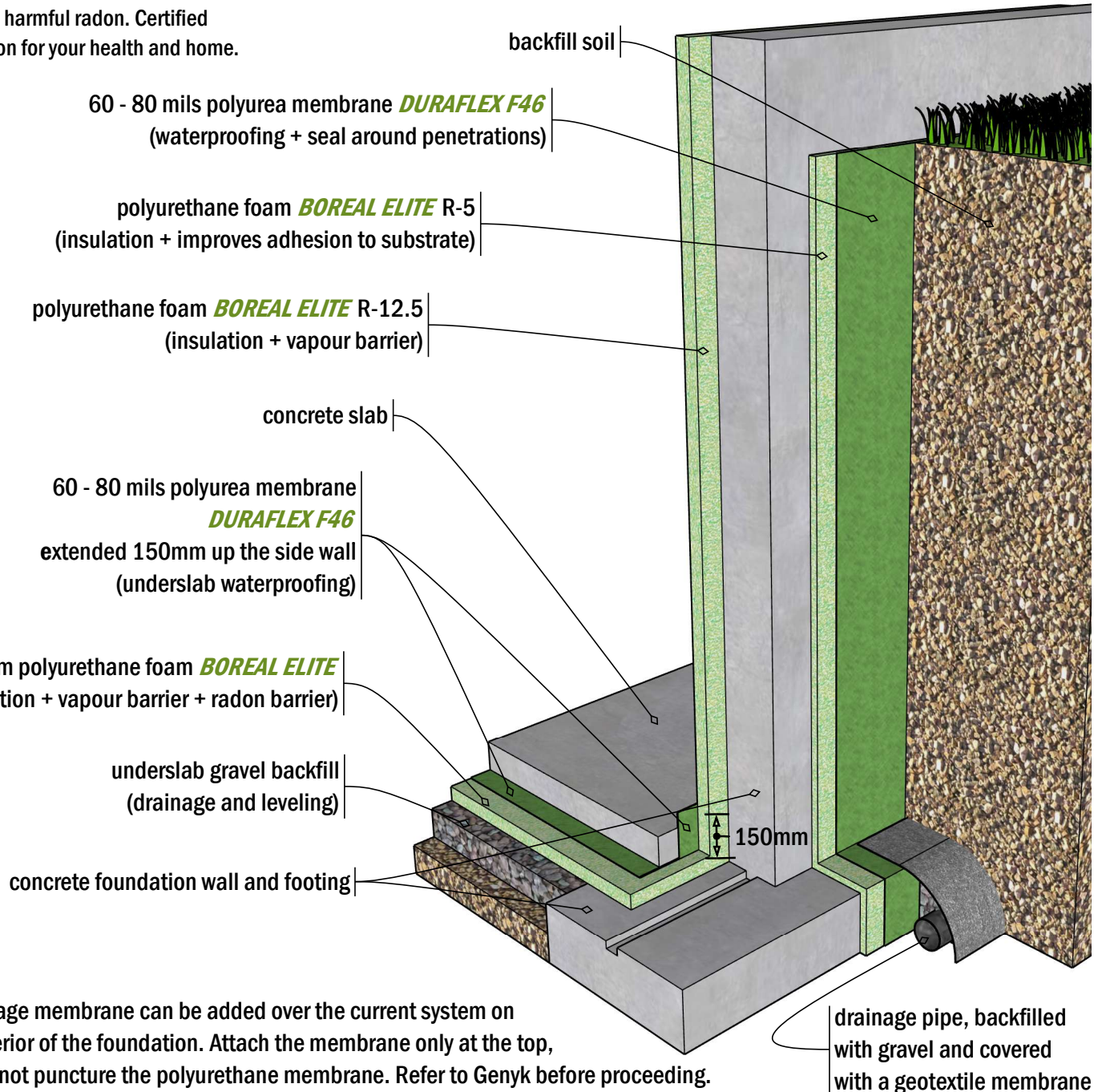

NOTE

A drainage membrane can be added over the current system on the exterior of the foundation. Attach the membrane only at the top, and do not puncture the polyurethane membrane. Refer to Genyk before proceeding.

+ please ensure compliance with local authority regulations concerning the R-values & the vapour barrier of the assemblies

LEGEND

- BOREAL ELITE
- DURAFLEX F46

PIERRE-LUC ST-LOUIS - Building Science Technician

DATE

May 2nd, 2025

REV #

REV-0

PROUDLY
CANADIAN.

Effective for High Water Table:

Engineered to resist groundwater pressure, ensuring dry, protected spaces even in challenging conditions.

High Performance &

Durability: Delivers reliable insulation and long-term structural resilience.

Vapour Barrier Solution:

Prevents moisture build-up, enhancing indoor comfort and safeguarding materials.

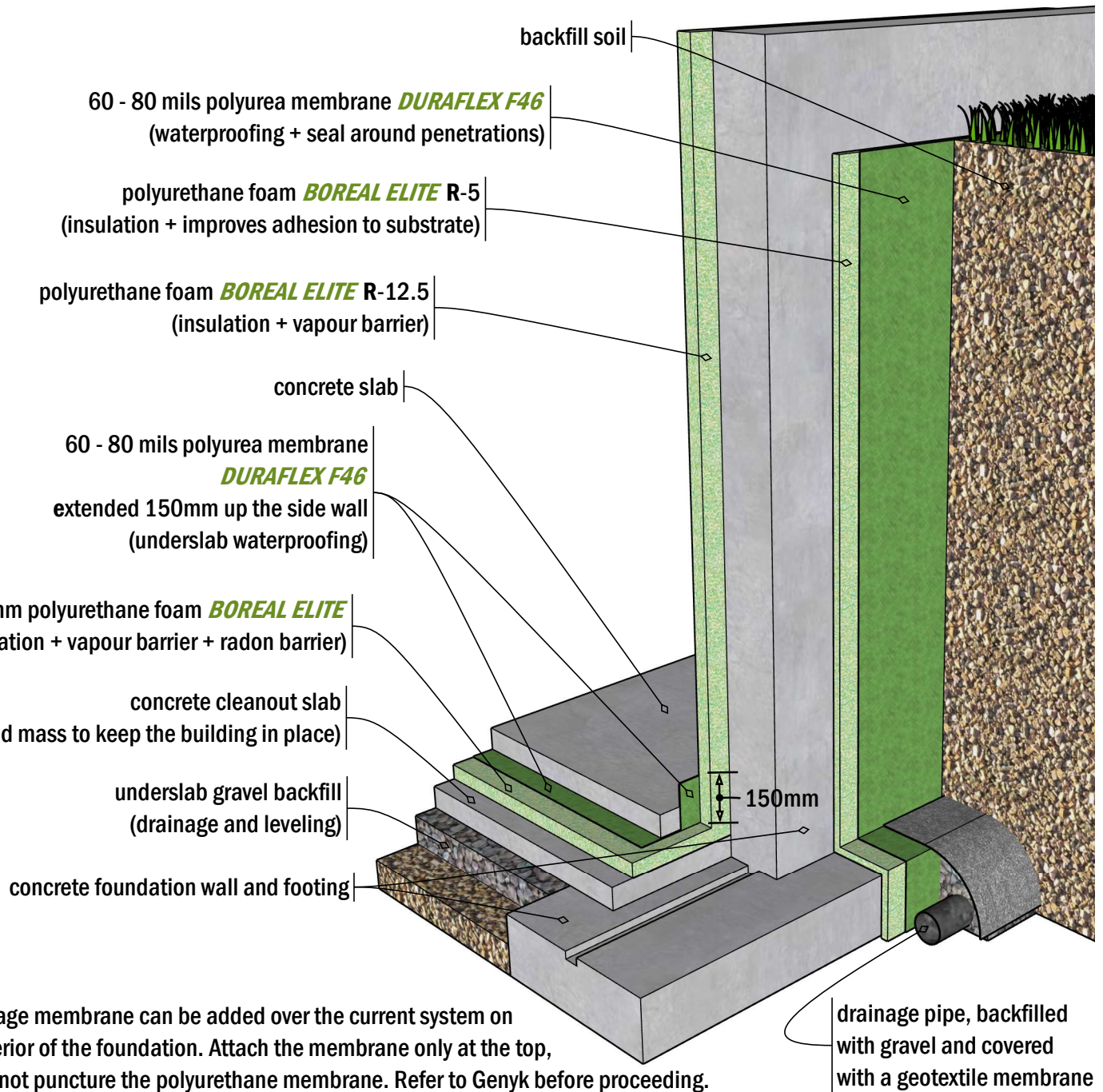

NOTE

A drainage membrane can be added over the current system on the exterior of the foundation. Attach the membrane only at the top, and do not puncture the polyurethane membrane. Refer to Genyk before proceeding.

+ please ensure compliance with local authority regulations concerning the R-values & the vapour barrier of the assemblies

LEGEND

- BOREAL ELITE
- DURAFLEX F46

PIERRE-LUC ST-LOUIS - Building Science Technician

DATE

May 2nd, 2025

REV #

REV-0

**PROUDLY
CANADIAN.**

Quick Application:

Fast and efficient installation, saving time without compromising quality.

Seamless Membrane:

Delivers a uniform, joint-free barrier for superior waterproofing performance.

Easy to Seal Around Elements:

Adapts effortlessly to complex details, ensuring full, reliable coverage.

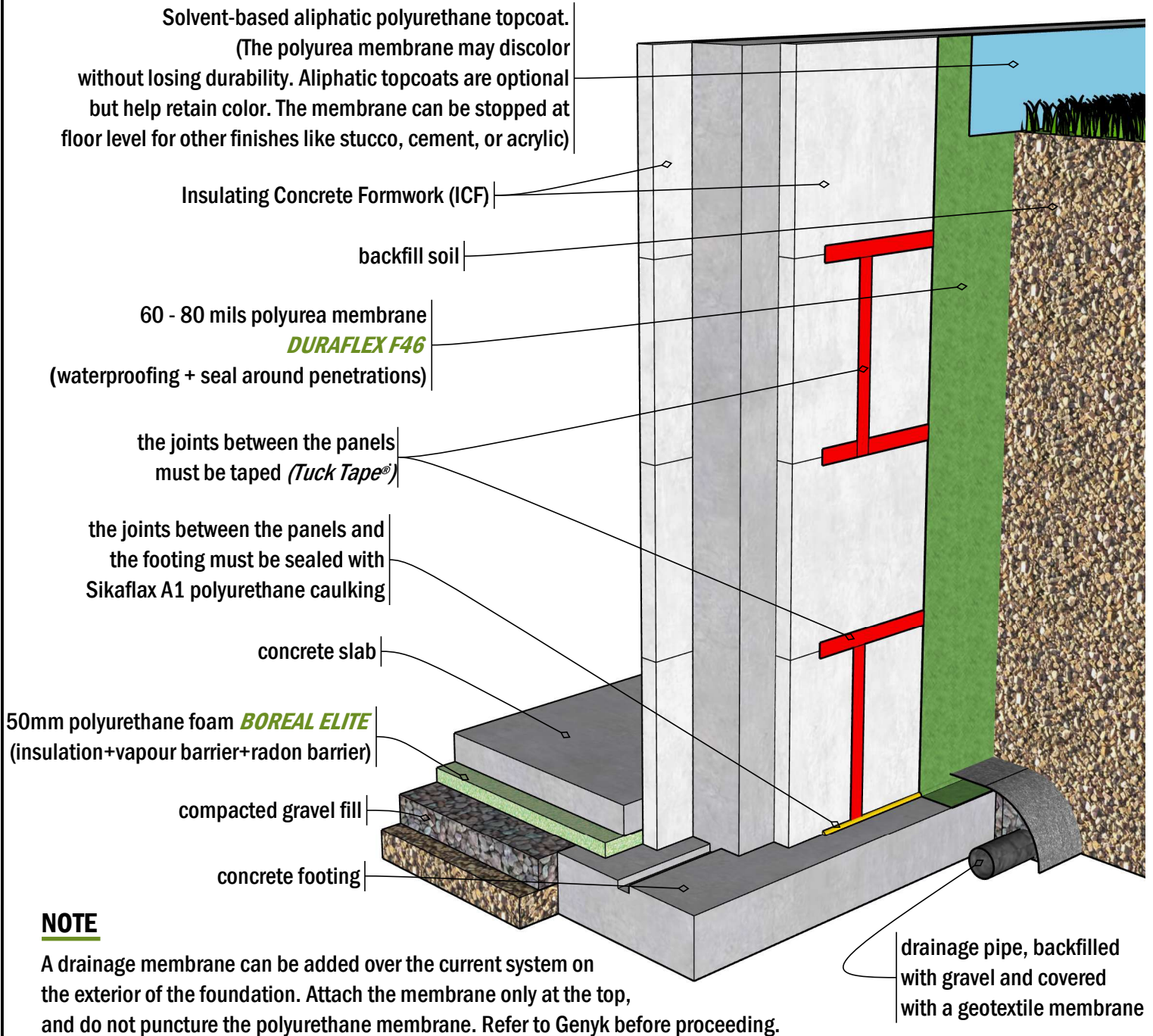

NOTE

A drainage membrane can be added over the current system on the exterior of the foundation. Attach the membrane only at the top, and do not puncture the polyurethane membrane. Refer to Genyk before proceeding.

+ please ensure compliance with local authority regulations concerning the R-values & the vapour barrier of the assemblies

LEGEND

- BOREAL ELITE
- DURAFLEX F46

PIERRE-LUC ST-LOUIS - Building Science Technician

DATE

May 6th, 2025

REV #

REV-0

**PROUDLY
CANADIAN.**

Reduced Construction Time:

Speeds up project timelines, helping you save on labor and costs.

Seamless Membrane:

Delivers a uniform, joint-free barrier for superior waterproofing performance.

Easy to Seal Around Elements:

Adapts effortlessly to complex details, ensuring full, reliable coverage.

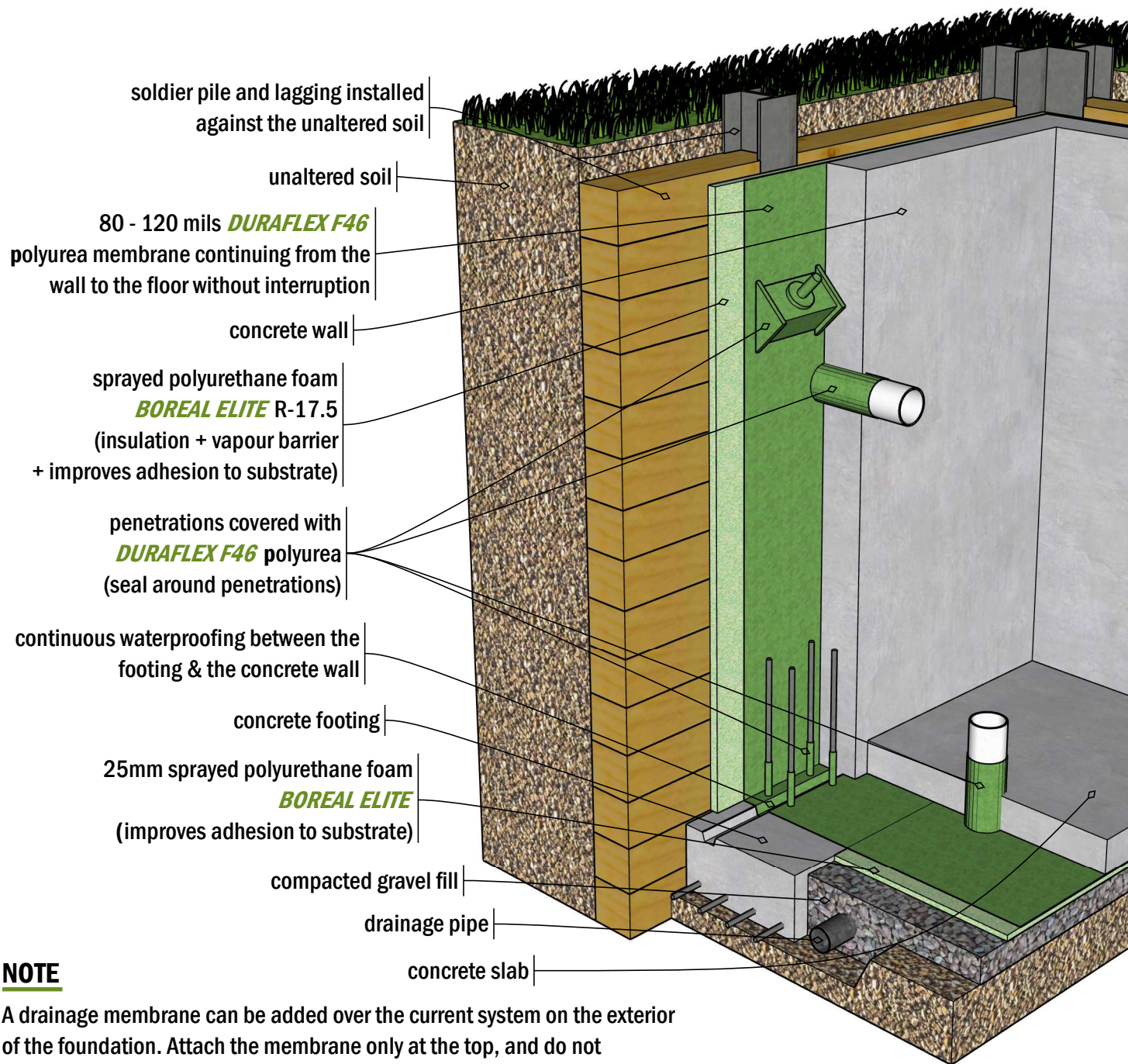

NOTE

A drainage membrane can be added over the current system on the exterior of the foundation. Attach the membrane only at the top, and do not puncture the polyurethane membrane. Refer to Genyk before proceeding.

+ please ensure compliance with local authority regulations concerning the R-values & the vapour barrier of the assemblies

LEGEND

- BOREAL ELITE
- DURAFLEX F46

PIERRE-LUC ST-LOUIS - Building Science Technician

DATE

REV #

May 2nd, 2025

REV-0

PROUDLY CANADIAN.

Reduced Construction Time:

Speeds up project timelines, helping you save on labor and costs.

Seamless Membrane:

Delivers a uniform, joint-free barrier for superior waterproofing performance.

Easy to Seal Around Elements:

Adapts effortlessly to complex details, ensuring full, reliable coverage.

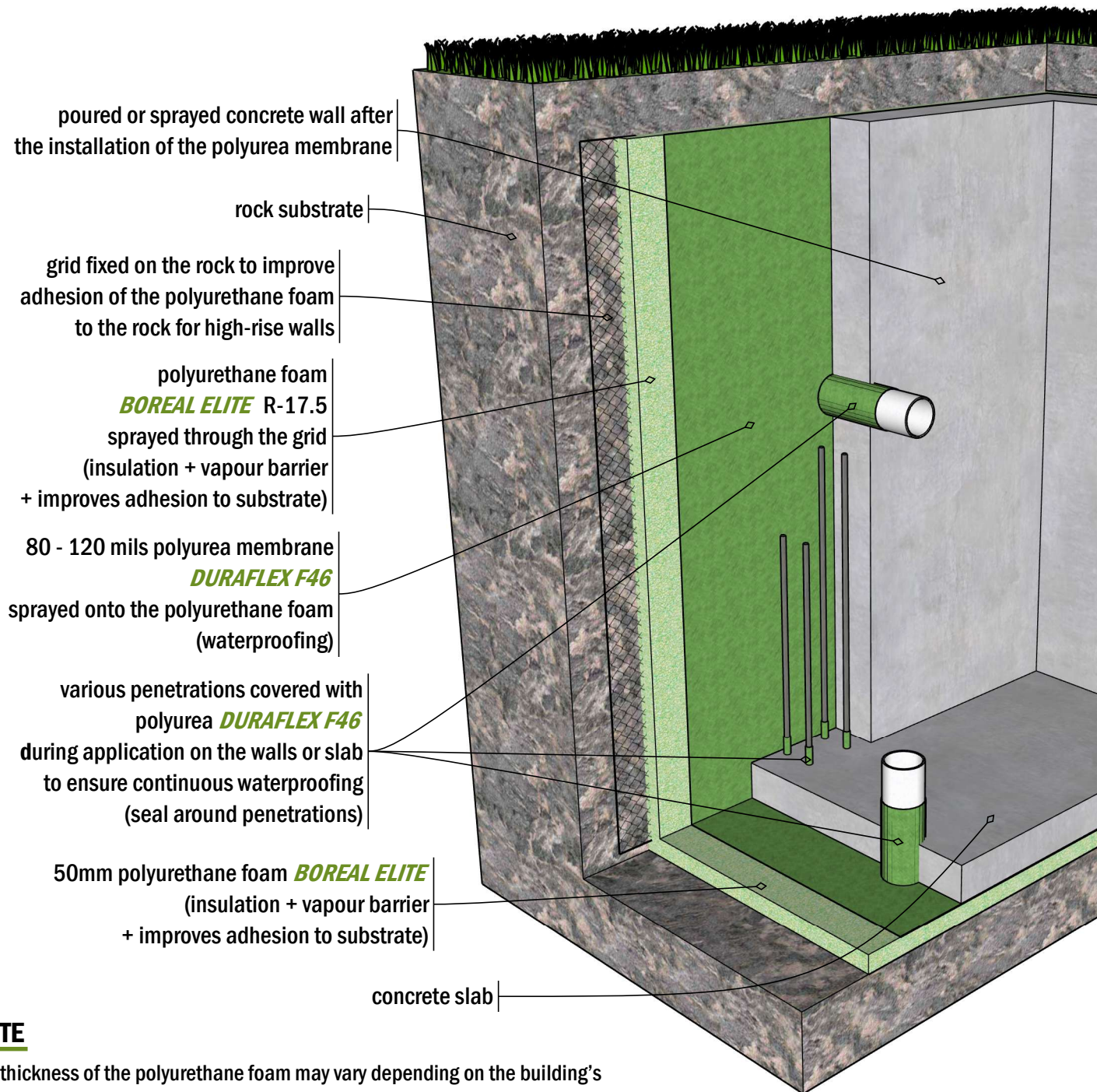

NOTE

The thickness of the polyurethane foam may vary depending on the building's intended function or usage requirements

+ please ensure compliance with local authority regulations concerning the R-values & the vapour barrier of the assemblies

LEGEND

- BOREAL ELITE**
- DURAFLEX F46**

PIERRE-LUC ST-LOUIS - Building Science Technician

DATE

May 2nd, 2025

REV #

REV-0

PROUDLY
CANADIAN.